

## ISTRUZIONI DI MONTAGGIO

# NEOSCENICA®

## V1 STANDARD – 1 BATTENTE CON BIADESIVO

### DISTINTA

- 1 Zanzariera
- 2 Profilo compensatore
- 3 Biadesivo per profilo compensatore
- 4 Profilo di riscontro (opt)
- 5 Profilo di scorrimento (opt)
- 6 Molla di spinta
- 7 Gruppo di spinta
- 8 Supporto cassonetto
- 9 Piastrina a pavimento

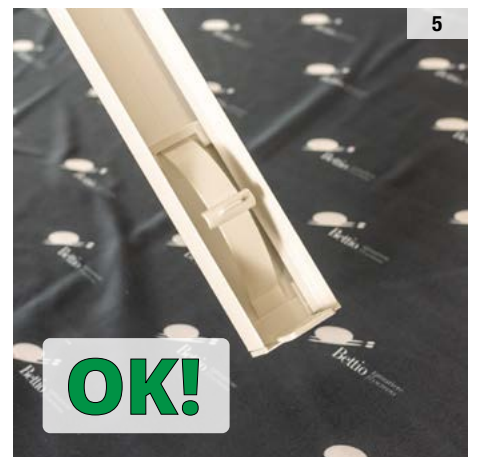
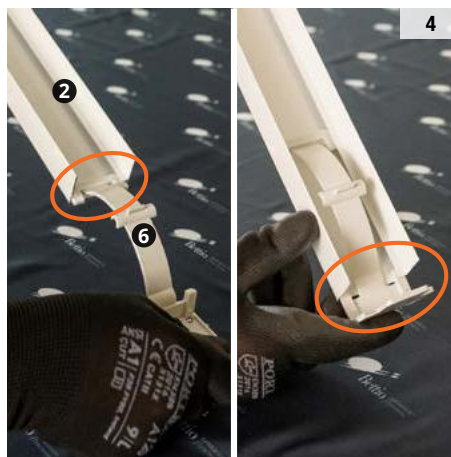
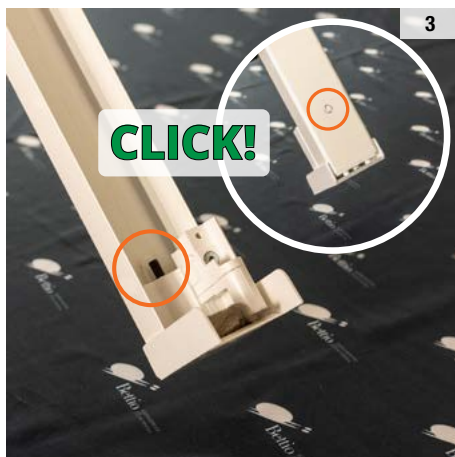
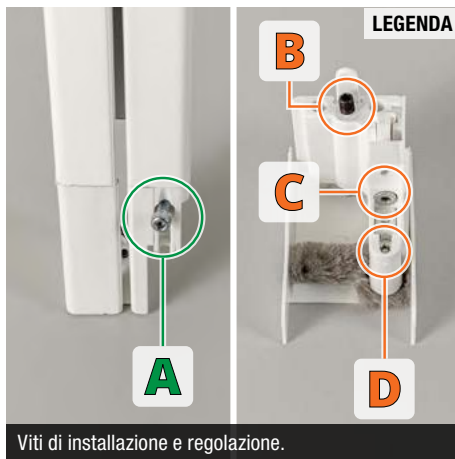
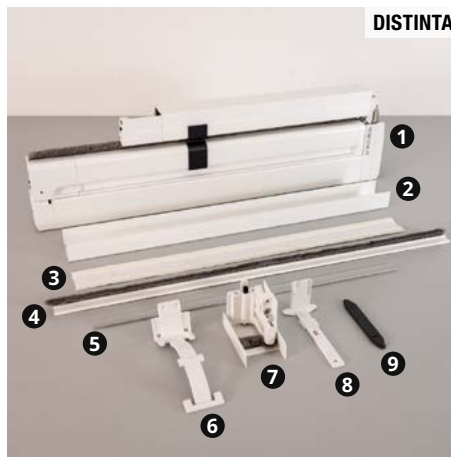



6

Sgrassare e asciugare la superficie di fissaggio prima di incollare il biadesivo: la completa adesione si ottiene dopo almeno 24 ore.

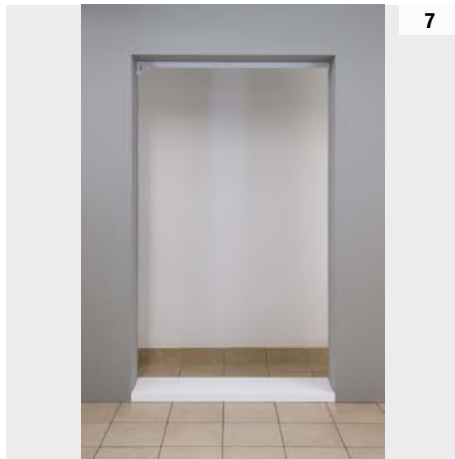

7

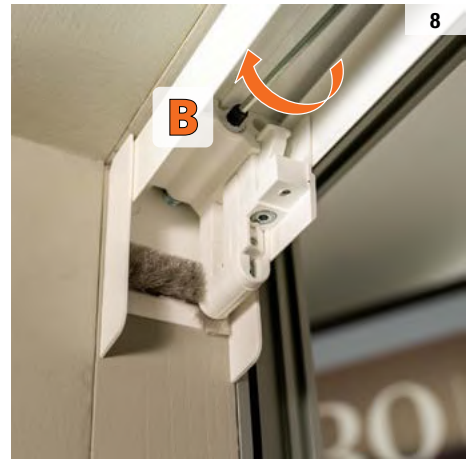

8

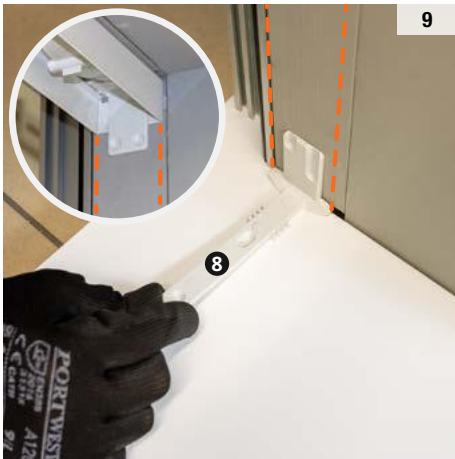

9



10

Installazione con biadesivo.  
Sgrassare e asciugare la superficie di fissaggio prima di incollare il biadesivo: la completa adesione si ottiene dopo almeno 24 ore.

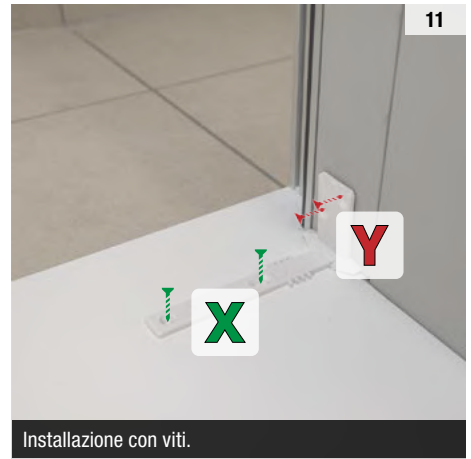

11

Installazione con viti.

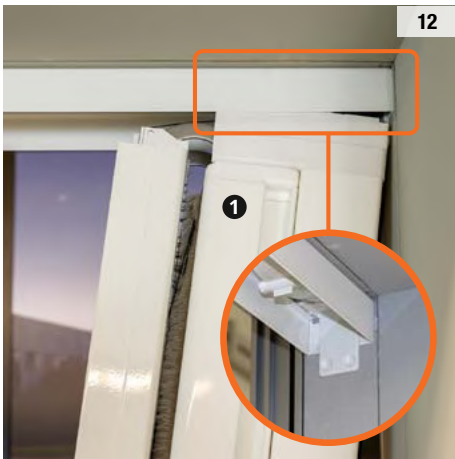

12



13

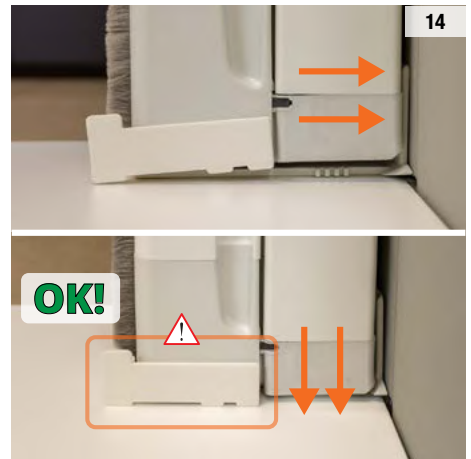

14



15

Accompagnare la guida senza forzare il movimento.



16

Avvitare completamente la vite.

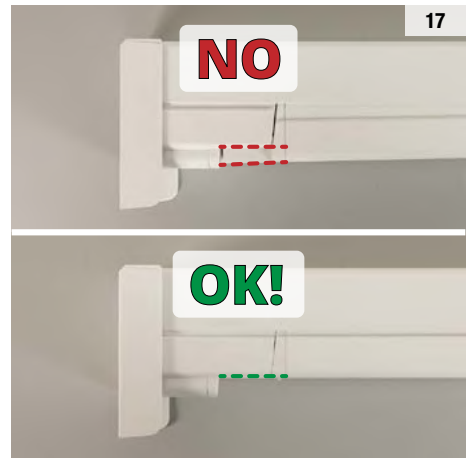

17

NO

OK!

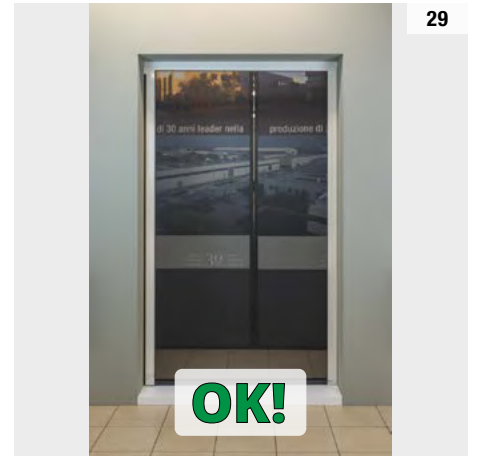
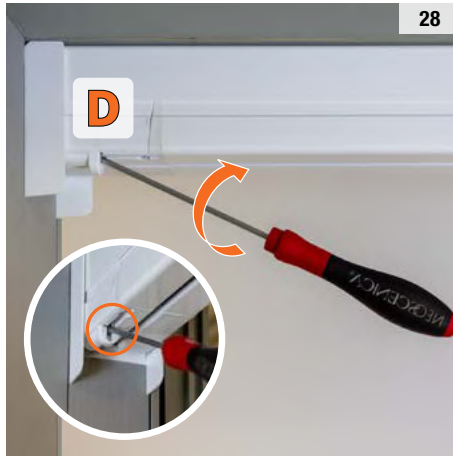
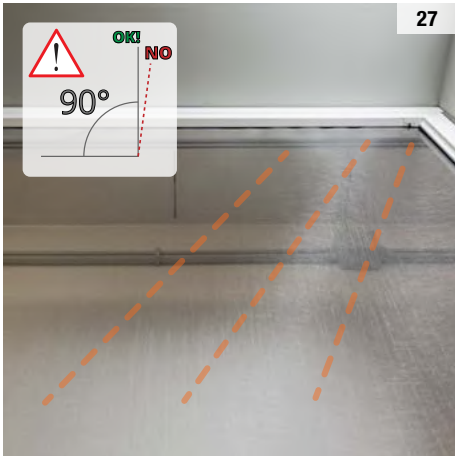
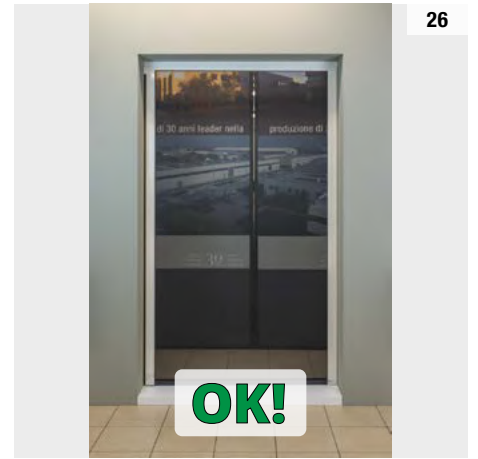
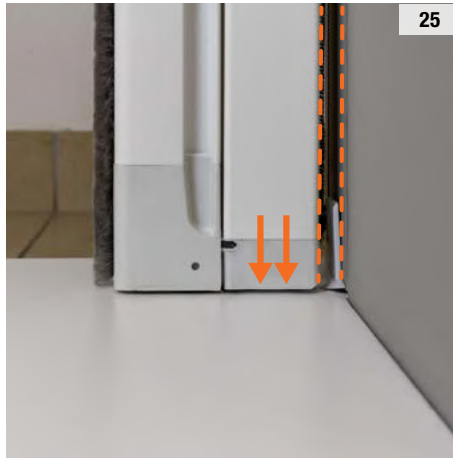
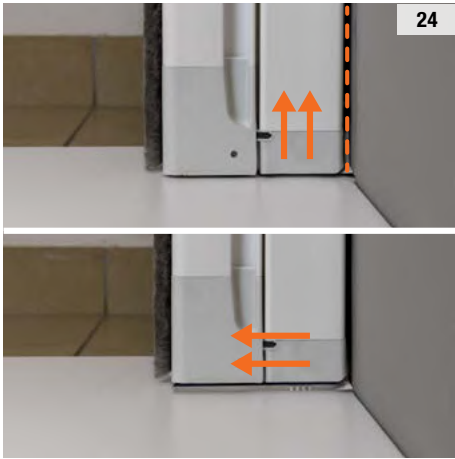
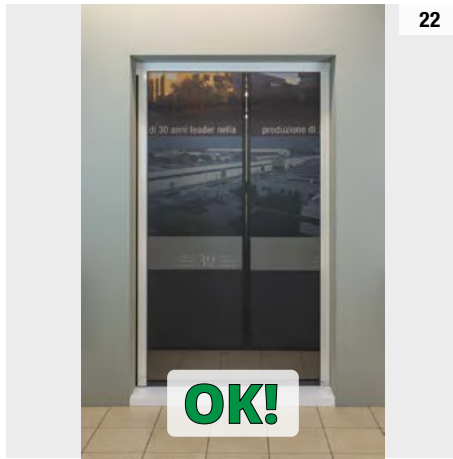
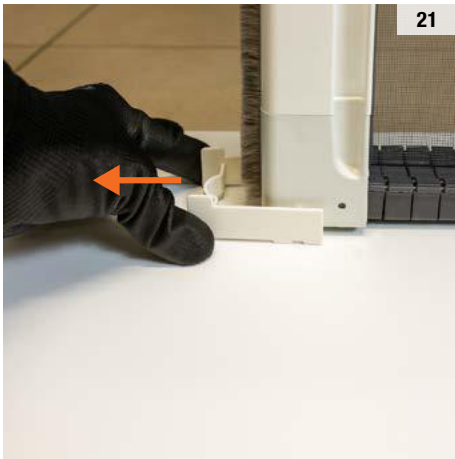

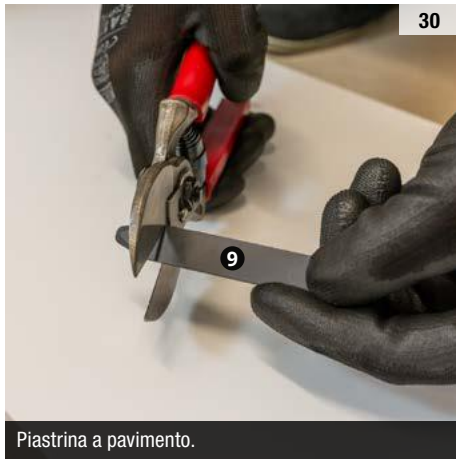

INQUADRA IL QR CODE  
PER VEDERE IL TUTORIAL  
DI INSTALLAZIONE